

Powerdot Compact 61

9356606101

9356606109

A - Removable installation

B - Permanent installation

CONTENT



- 1 **USB Charger**
(QC2.0 : 5V 2A /
9V 1.2A / 12V 1A)

- 1 **Type B socket**
/w 1800 mm cable

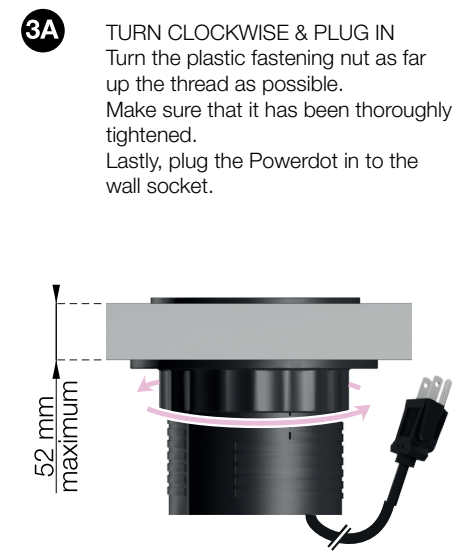
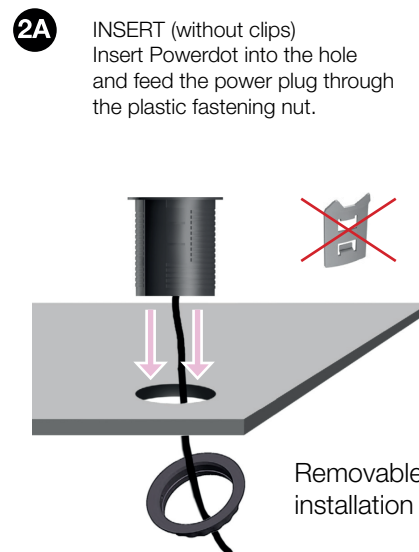
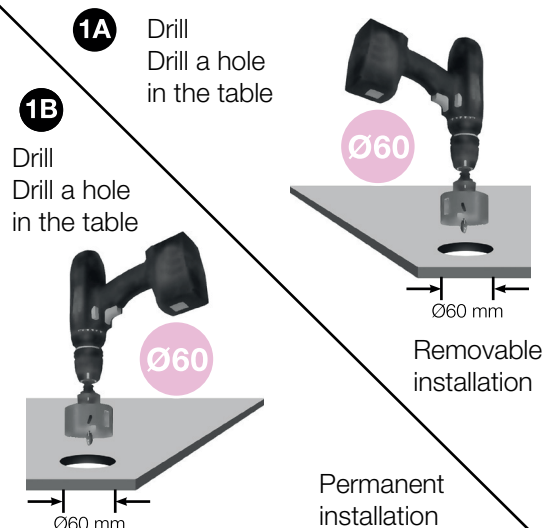

2B ATTACH AND INSERT (NON REMOVABLE)
Attach clips by guiding them into the side tracks.
The clips will keep the product in place without
the fastening nut.
Push the Powerdot all the way down the hole.
Lastly, plug the Powerdot in to the wall socket.

NOTE! Removing the product once inserted
can damage the table and /or the product.

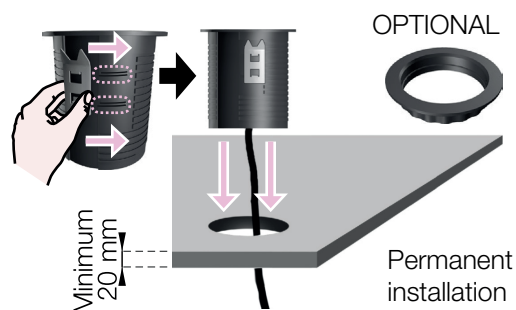

HOW TO REMOVE (WITH CLIPS)
To minimize the risk of damaging the table
and/or product, turn the grommet clockwise
until the clips re-position and loosen up.

NOTE! Removing the product once inserted
can damage the table and /or the product.

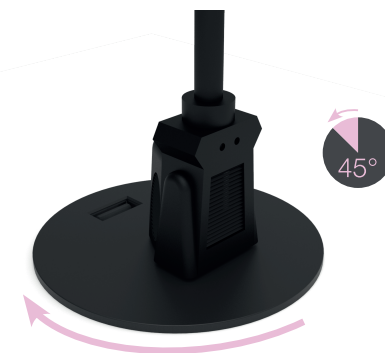

PULL UPWARD
When the clips are loose, pull
the Powerdot upward until fully removed.

