

# NOMAD STRIP<sup>05</sup>

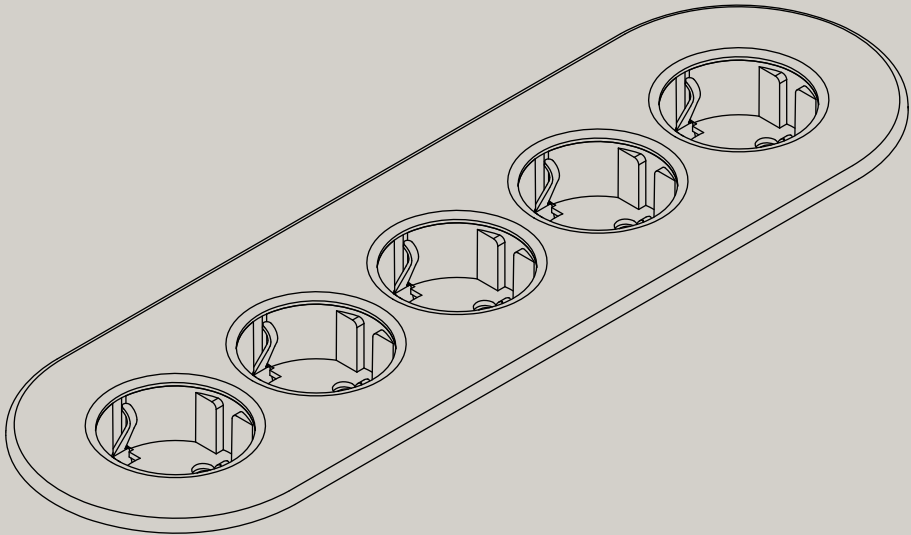

# Product overview

See user manual for assembly instructions

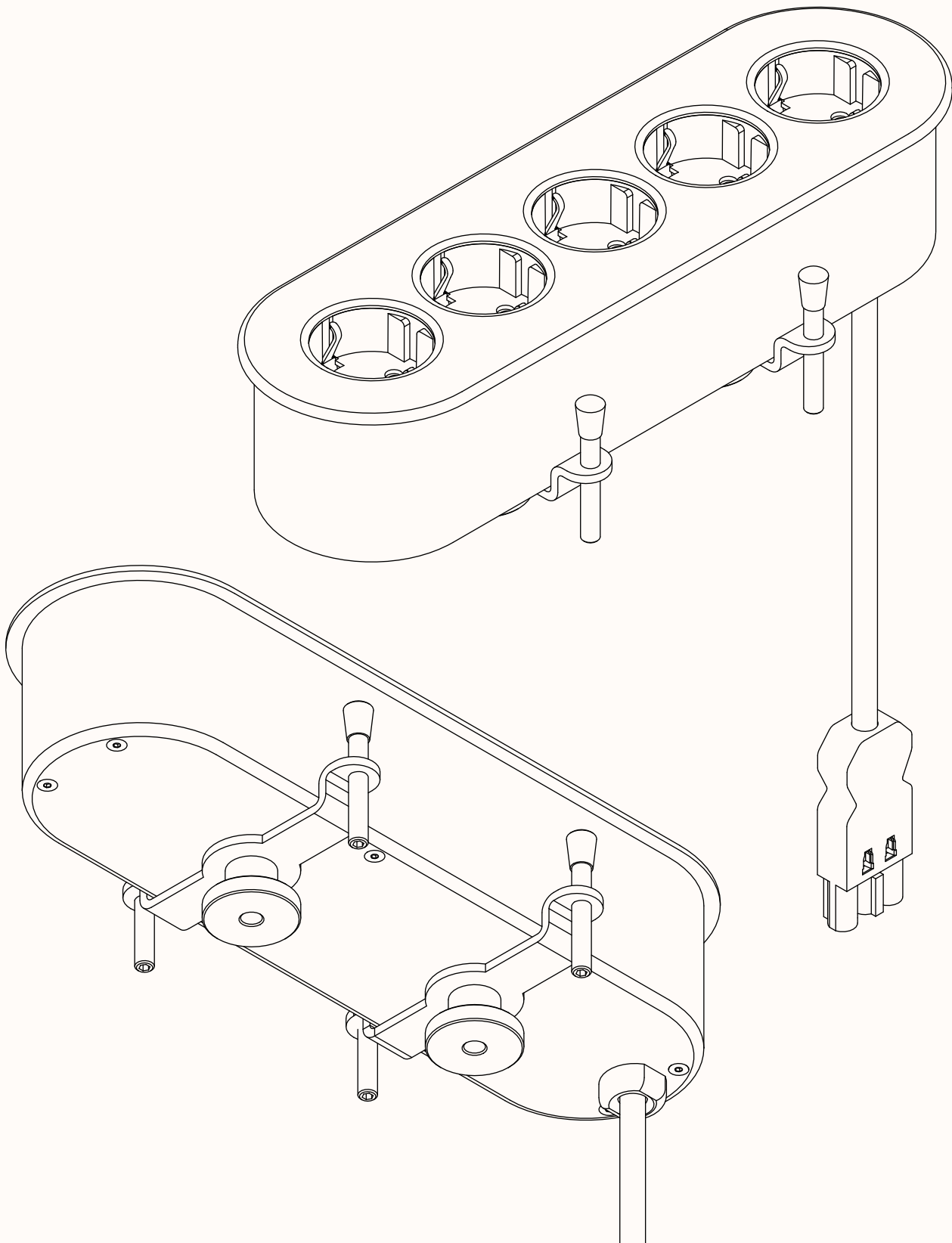

# Product dimensions

See user manual for assembly instructions

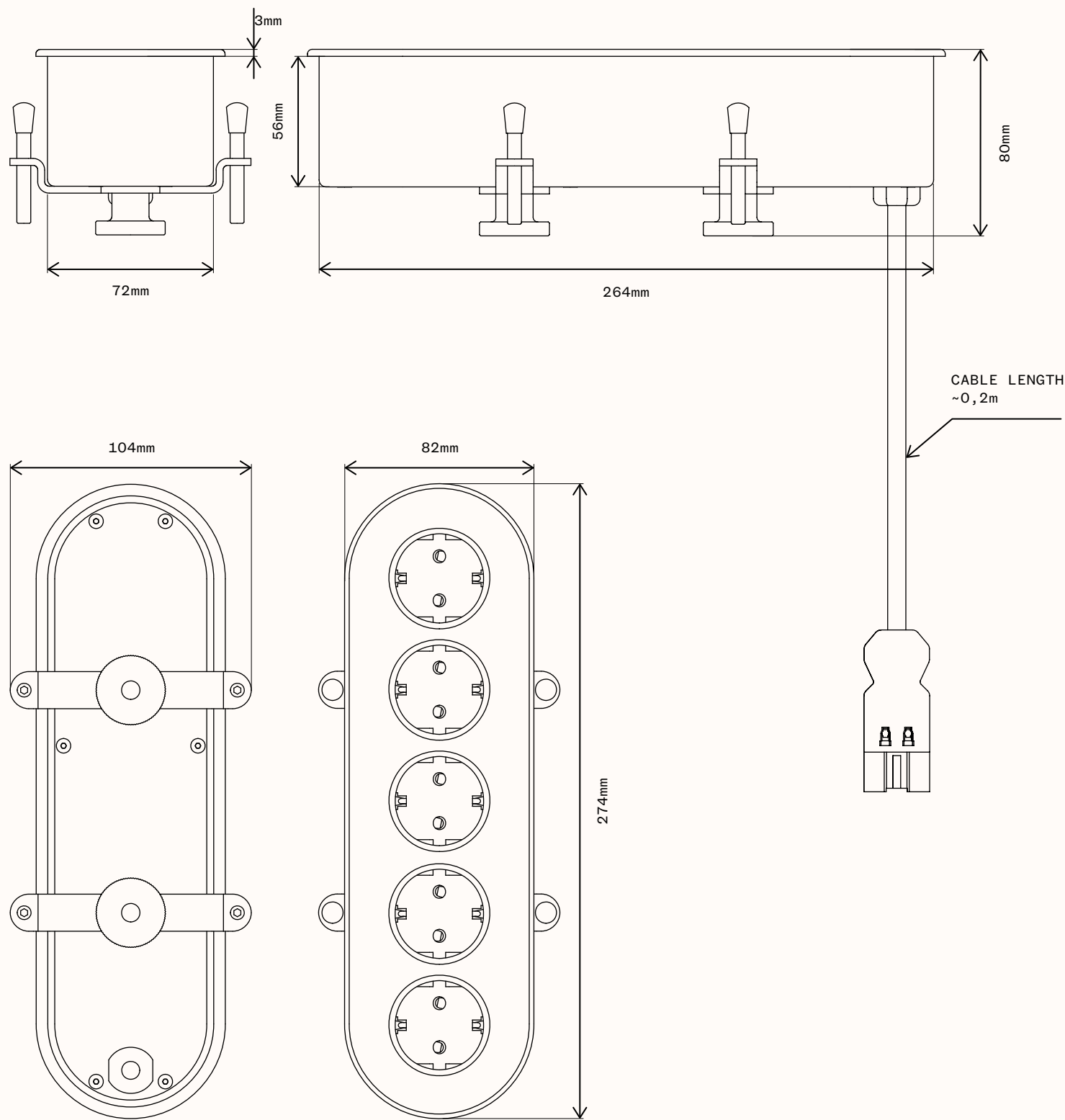

# Table dimensions

See user manual for assembly instructions

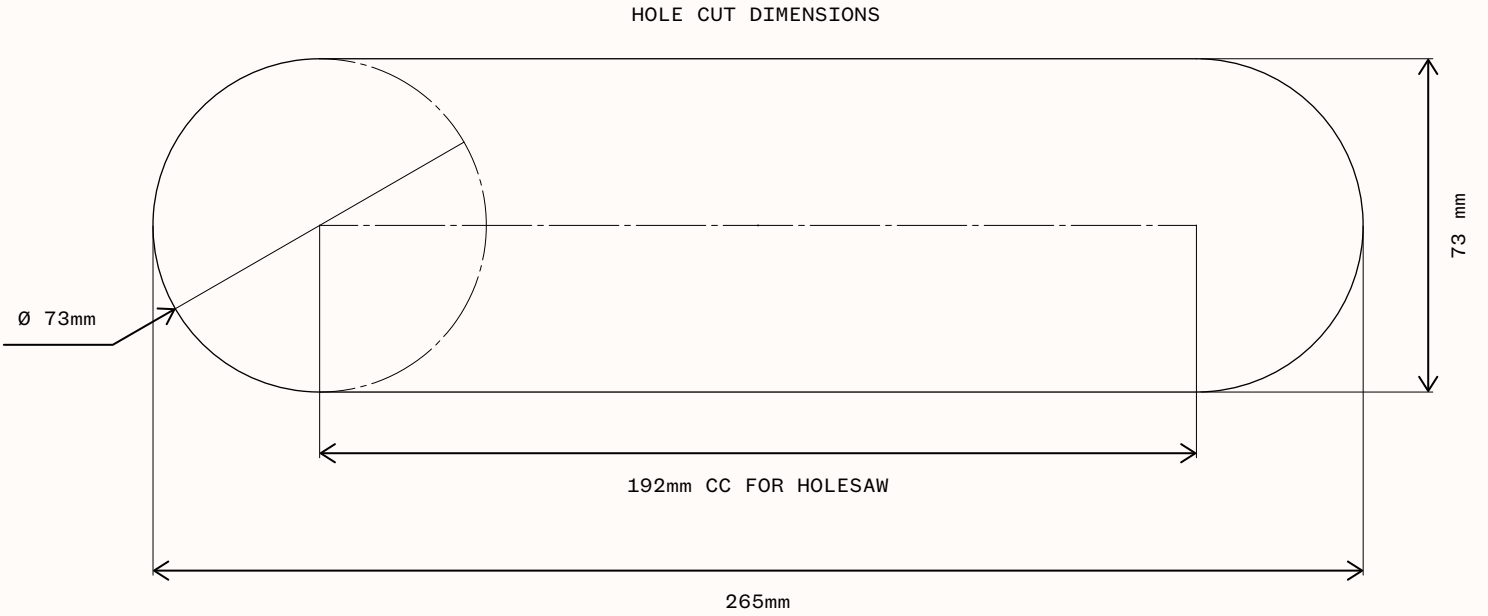
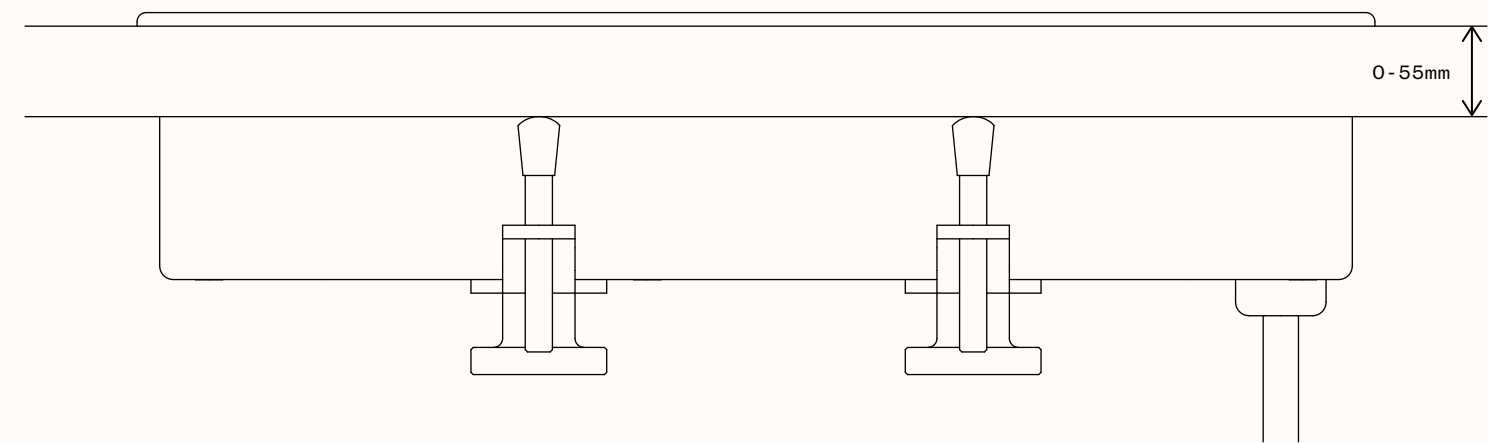

# Colours

---



SIGNAL BLACK  
RAL 9004  
DEEP MATTE, FINE STRUCTURE  
ART. NO 9808055109

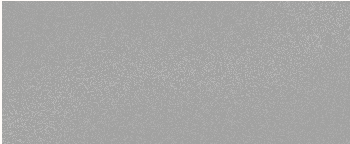

WHITE ALUMINIUM GREY  
RAL 9006  
MATTE, FINE STRUCTURE  
ART. NO 9808055102

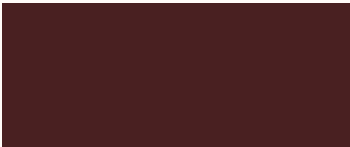

BLACK RED  
RAL 3007  
DEEP MATTE, FINE STRUCTURE  
ART. NO 9808055106



STONE CYPRESS GREEN  
RAL 160 50 15  
DEEP MATTE, FINE STRUCTURE  
ART. NO 9808055105



VIOLET BLUE  
RAL 5000  
MATTE, FINE STRUCTURE  
ART. NO 9808055104



VERMILION RED  
RAL 2002  
MATTE, FINE STRUCTURE  
ART. NO 9808055111

# NOMAD STRIP<sup>05</sup>

5 SOCKET TYPE F, GST18i3

## Technical data

INTERFACE	5 POWER SOCKETS TYPE F
RATED VOLTAGE	250V
RATED CURRENT	16A
OUTPUT W MAX	3500W
CABLE AND CONNECTOR	3x1,5mm <sup>2</sup> , ~0,2m, GST-18i3 PLUG
MATERIAL OUTER CASING	RECYCLED ALUMINIUM
MATERIAL BOTTOM PLATE AND ENCLOSED ITEMS	STEEL
MATERIAL INNER COMPONENTS	PP AND PA6.6
FINISH	POWDER COATED
PROTECTION CLASS	IP20
MAX TABLE THICKNESS	55mm
CERTIFICATIONS	CE, RoHS COMPLIANT
WARRANTY PERIOD	3 YEARS

# Read before installation and usage

---



Do not cover

Electrical products may only be daisy-chained if integrated into a fixed installation. Normal power sockets may not be used for the connection to further socket rails.



Incorrect installation may endanger:

- Safety of the installer
- Safety of the end-user and safety of the property.

Incorrect installation may result in personal liability for damage of property or injury to persons.



Electronic equipment is recyclable and should not be disposed of with household waste, if the device has reached the end of its life, dispose of at the recycling points in accordance with local regulations. Disposal with household waste is prohibited



The device may only be used in a dry indoor environment.

For safe installation please ensure the following:

- The 5 safety rules to apply: Disconnect mains; Prevent reconnection; Test for absence of harmful voltages; Ground and short circuits; Cover or close off nearby live parts;
- Choose proper tools, measuring devices and personal protective equipment
- Analyse measured results
- Selection of electrical installation material to ensure switch-off conditions
- IP protection ratings
- Fitting of electrical installation material;
- Type of the feeding system (TN system, IT system, TT system...) and the resulting switching conditions (classic zeroing, protective earthing, necessary additional measures, etc.).



**RoHS**  
Compliant