

# Elevate Monitor Arm<sup>50</sup>

## PARTS AND TOOLS

(A)	x1	PCE	
(B)	x1	PCE	
(C)	x4	PCS	M4x10
(D)	x1	PCE	M4x10
(E)	x1	PCE	2mm
(F)	x1	PCE	6mm
(G)	x1	PCE	4mm
(H)	x1	PCE	5mm
(I)			NOT INCLUDED

Follow instructions, and if there are steps that are incomprehensible, please let us know and we will get back to you. For assembly, use only prescribed tools.

FORMINGFUNCTION.SE

FORMING ℒ FUNCTION

USER MANUAL

### STEP 1

Loosen the two upper set screws in the table clamp and remove them.

Remove the arm.

Set the arm and set screws aside, they will be reinserted in STEP 3.

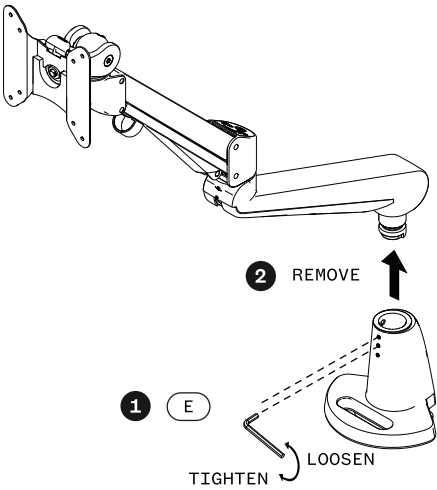

### STEP 2

Turn the table clamp upside down, and adhere the rubber pad (B).

Turn the table clamp over again. Loosen the center bolt enough so that the clamp fits around the edge of your table.

Once in place around the edge of your table, tighten the center bolt using Allen Key (F) until you feel resistance.

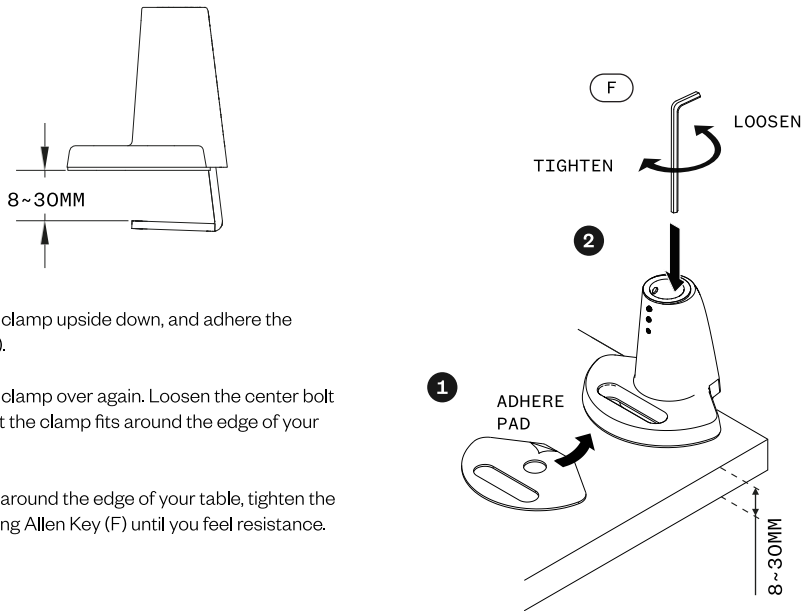

### STEP 3

Reinsert the arm in the table clamp and reattach the set screws from STEP 1.

Tighten the middle screw fully, and then loosen it one turn.

Check that the arm cannot be removed.

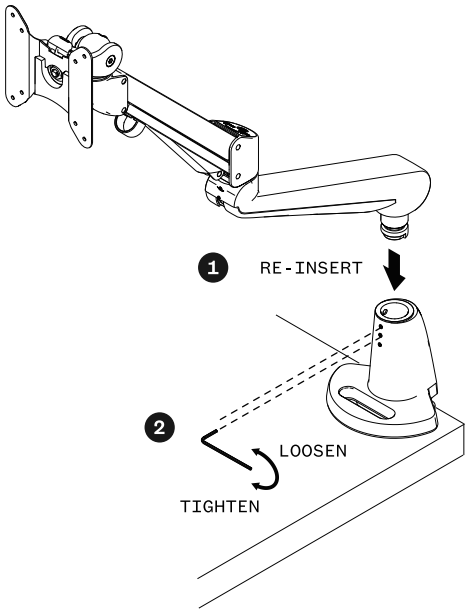

### STEP 4

Remove the VESA plate by pinching the grey plastic tab to release the lock, then pull the VESA plate upwards to separate it from the arm. Repeat for the second arm.

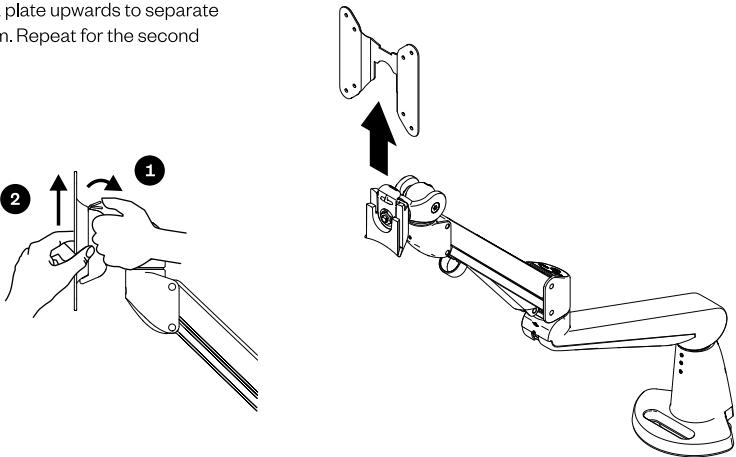

STEP 5

Place monitor face down on a flat surface. Align the VESA plate holes with the holes on the back of the monitor and attach using the screws for the desired monitor.

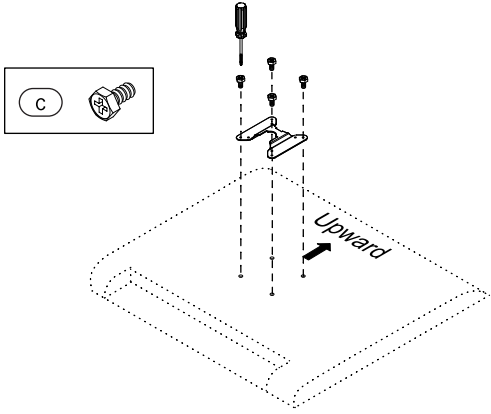
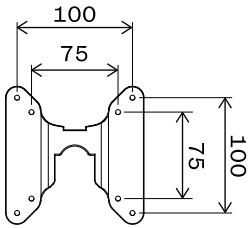

STEP 6

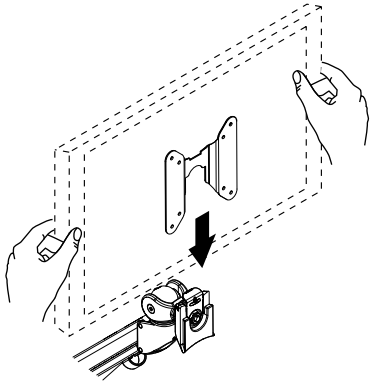

Use screwdriver to secure the screw.

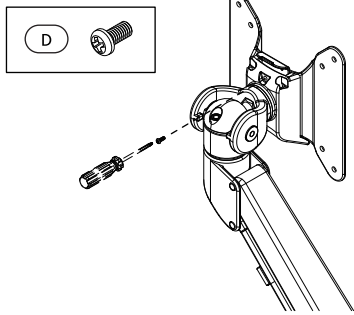

Slide the monitor (with VESA plate) onto the arm and make sure it "clicks" securely into position.

TENSION ADJUSTMENTS AND ROTATION LOCK

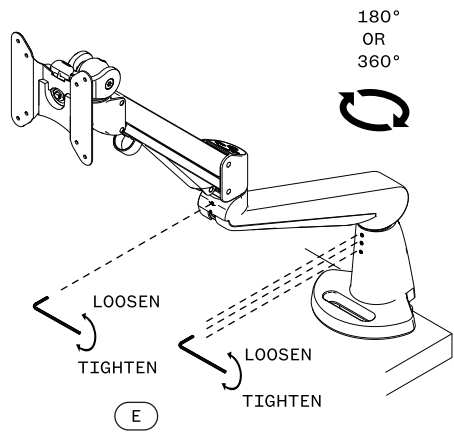

Adjust the tension of the rotation to your need by tighten or loosen the top screw.

To keep the arms completely rigid, fasten the the top screw as tight as possible while maintaning the intended position.

Fasten and loosen the middle screw one revolution to prevent the monitor arm from being removed.

To limit the rotational movements to 180°: Fasten the bottom screw and loosen one revolution.

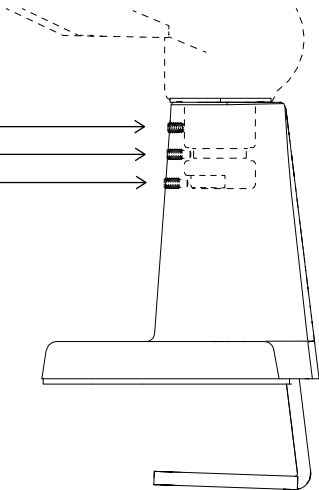

STEP 7

Unattach the cable collector and route the cables through. Once satisfied, re-attach the collector back into place.

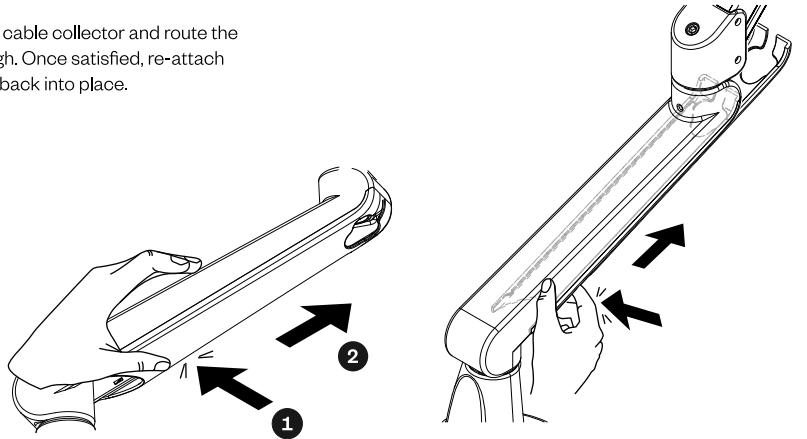

Proceed by continuing the routing through the cable clip.

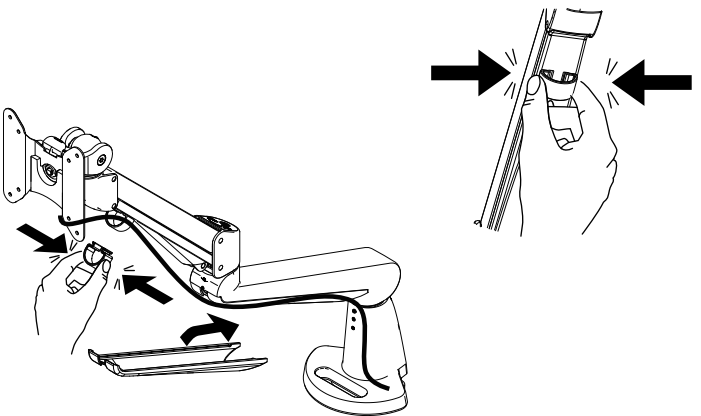

TENSION ADJUSTMENTS

CAUTION:  
Support and hold on to the arm while adjusting the tension.

ADJUSTMENT:  
Use the Allen key provided to adjust the tension to correspond to the weight of the desired monitor. Turn the Allen key (H) counter-clockwise to adjust for heavier monitors; clockwise for lighter monitors. Once the adjustment is done, the monitor should be experienced as weightless and the monitor should remain in any position without dropping nor rising.

- RECOMMENDATIONS:
- 3-8 kg (6.6-17.6 lbs).
  - The products loading capacities are based on monitors' center of gravity less than 3 cm from the end of the VESA interface.
  - Loading capacity could be reduced if the monitor size is greater than 26 inches or if the thickness exceeds 5.5 cm.
  - All product specifications in catalogues are subject to change without notice.

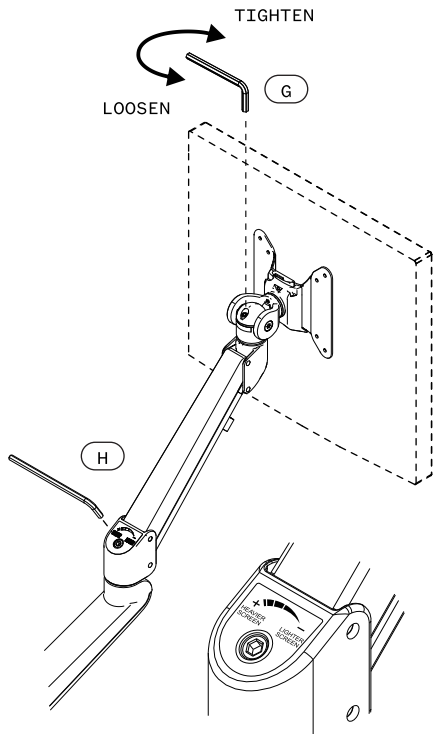

Allen keys can be stored on monitor arm

